



Electronic Safe

User Manual

For models:

VALUE-10HL (Home size)

VALUE-3HL (Laptop size)

VALUE-2HL (Office size)

VALUE-6HL (Compact size)

Focus on Smart Lock
Since 1992

Fitting guide

To reduce the risk of theft

To reduce the risk of theft, it is essential that your safe is securely fixed. Please use the included bolts and secure to a solid concrete floor.

For maximum performance and correct installation a profession locksmith must install the safe.

Before operating your new Be-Tech safe, please read the user manual

For any inquiries, please e-mail to info@be-tech.com.cn

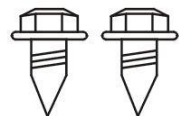

For furniture

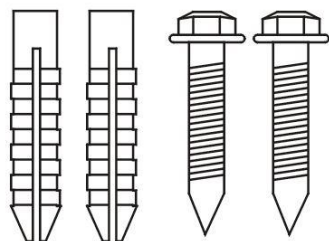

For solid concrete floor



Pencil

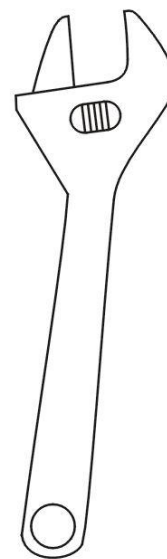

Spanner

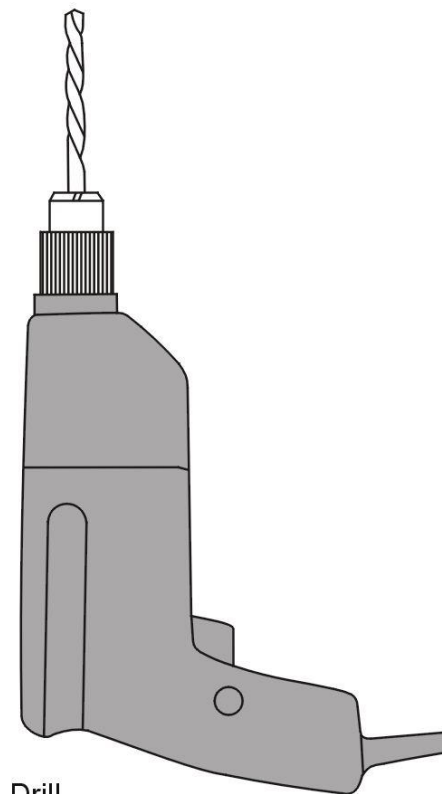

Drill

 The performance of the safe is dependant on the quality of the installation and the quality of material to which the safe is fixed.

 This product is heavy. Incorrect installation may result in injury.

Before fixing the safe please ensure:

- That the safe is placed horizontally
 - To keep the safe in a dry environment to prevent corrosion to the safe and locking mechanism
 - To use the fixing bolts provided for installation on a solid concrete floor.
-

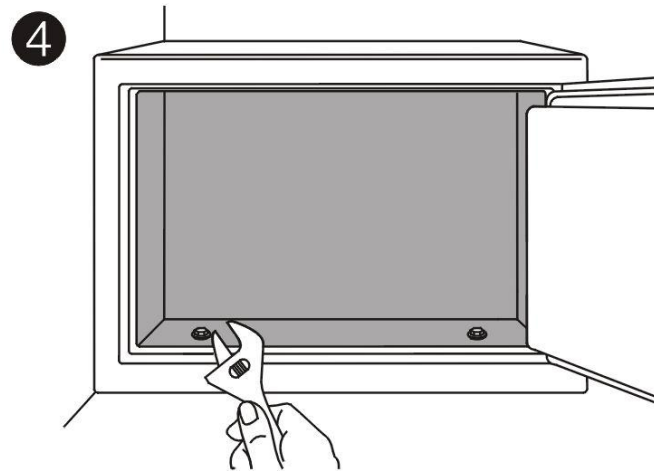
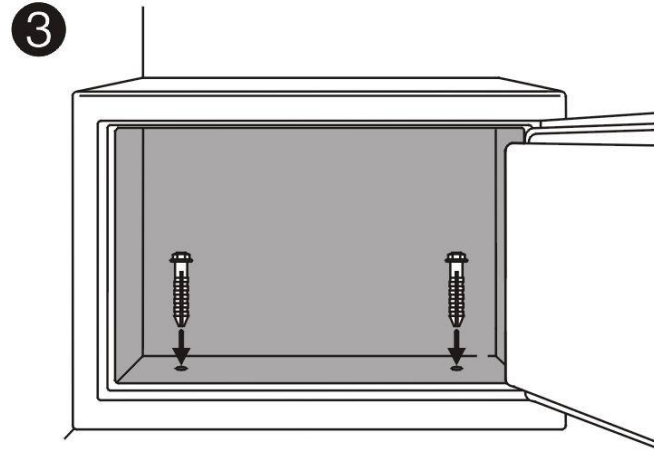
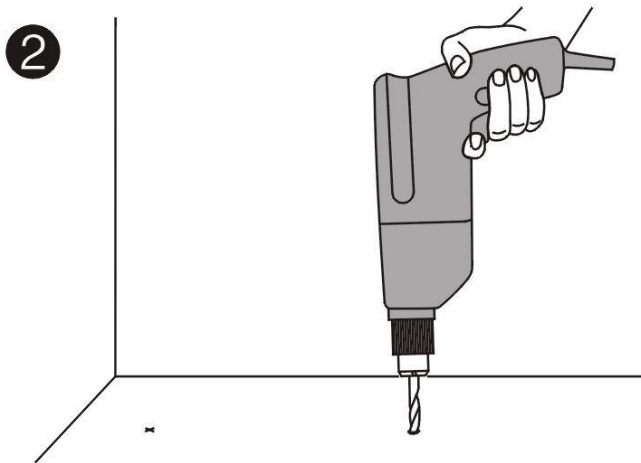
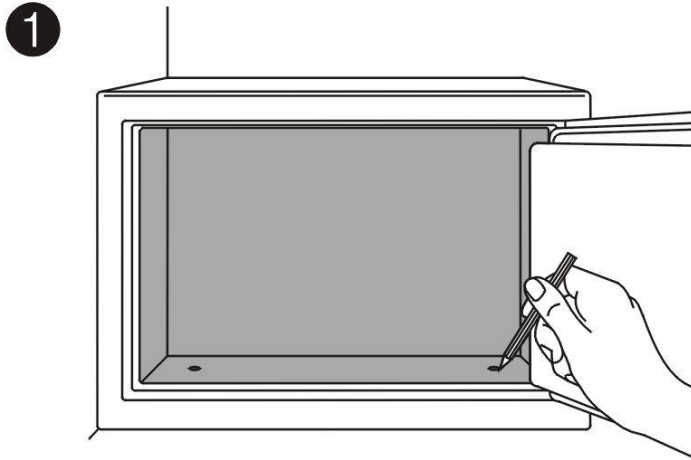

-
1. Mark the position of the safe through fixing holes.
 2. Remove the safe and drill the holes as marked.
 3. Reposition the safe over the holes

4. Drop the bolts through the safe and into the drilled holes. You may have use a hammer to drive the bolts down.
5. Tighten the fixing bolts firmly and ensure there is no movement of the safe

Quick start-up guide

Welcome!

Thank you for buying a Be-Tech safe.

Before operating your new BeTech safe, please read the user manual and fitting guide to ensure maximum performance.

For any inquiries, please e-mail to info@be-tech.com.cn



Please do not store the mechanical override keys inside the safe.

Setting your Master code

1 Unlock door

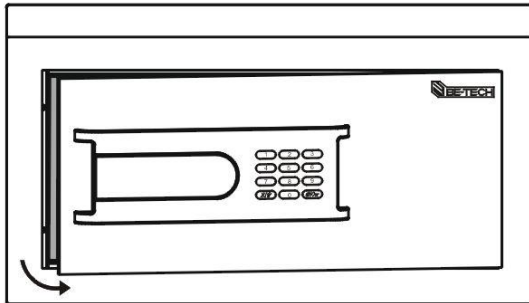

2 Press \ast/\varnothing → 1 → $\#/\text{On}$ ----

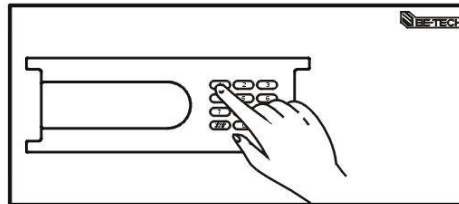

3 Display $\alpha\text{L}\text{C}\alpha$, enter 123456 → $\#/\text{On}$

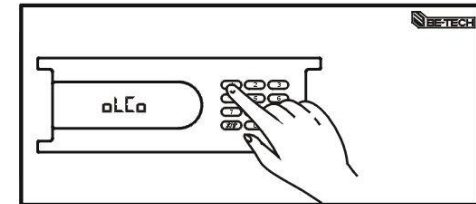

4 Display $\Xi\text{E}\text{C}\alpha$, enter new Master code → $\#/\text{On}$

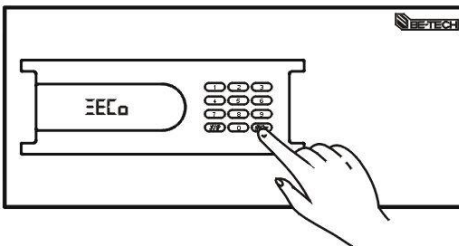

5 Display $\Gamma\text{E}\text{P}\text{E}$, repeat entering new Master code → $\#/\text{On}$

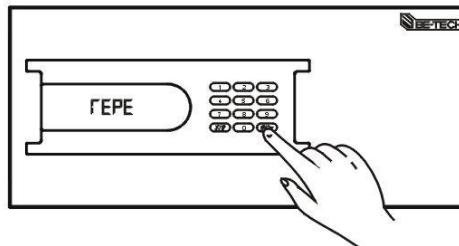

6 Display $\Xi\text{U}\text{C}\text{C}$, Master code is set

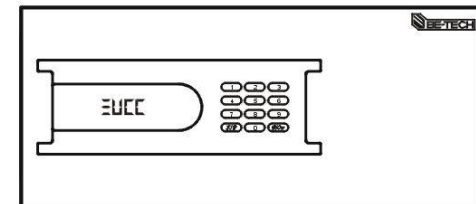

Opening the safe

① Enter Master code → **#/0π**

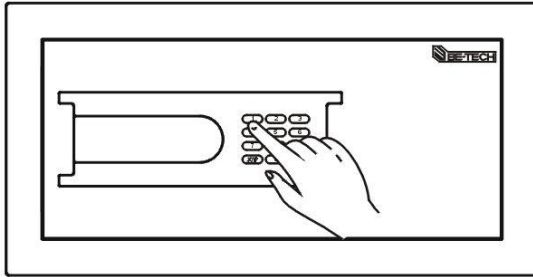

② Door open

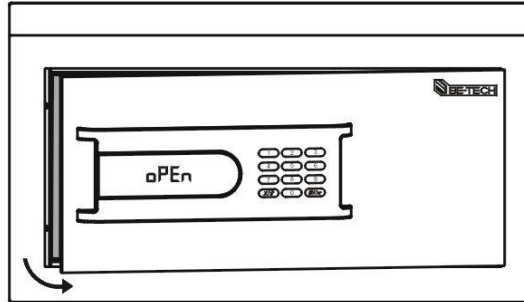

Closing the safe

① Close door

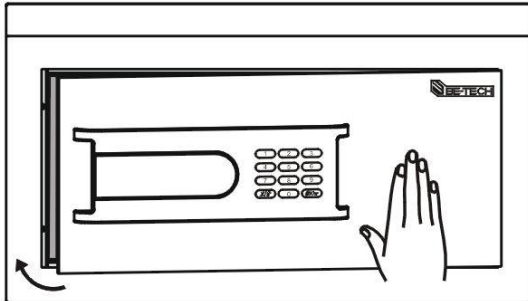

② Press **#/0π**

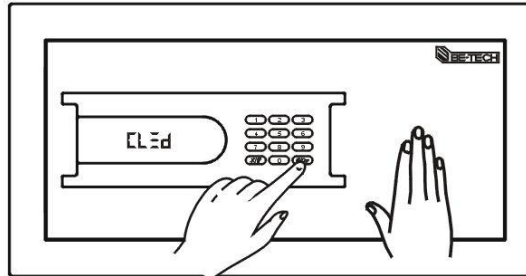

Safe overview

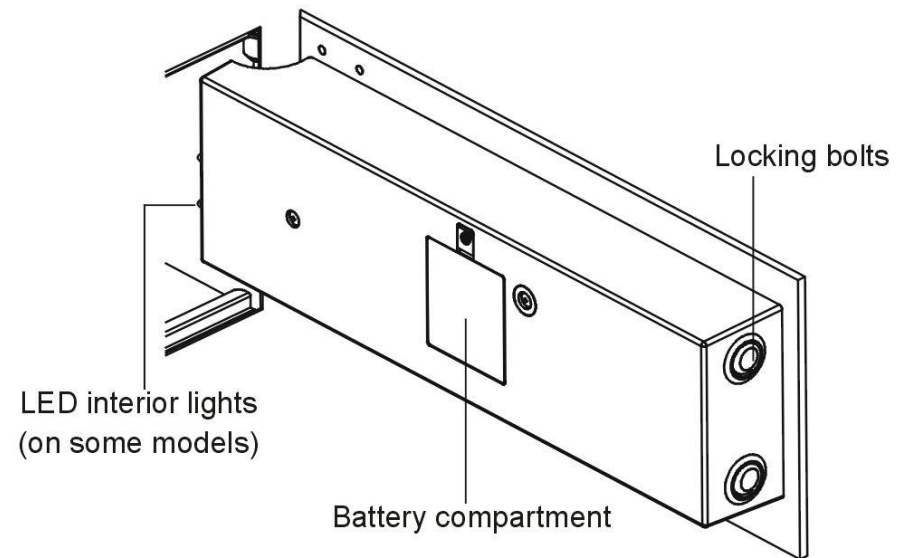
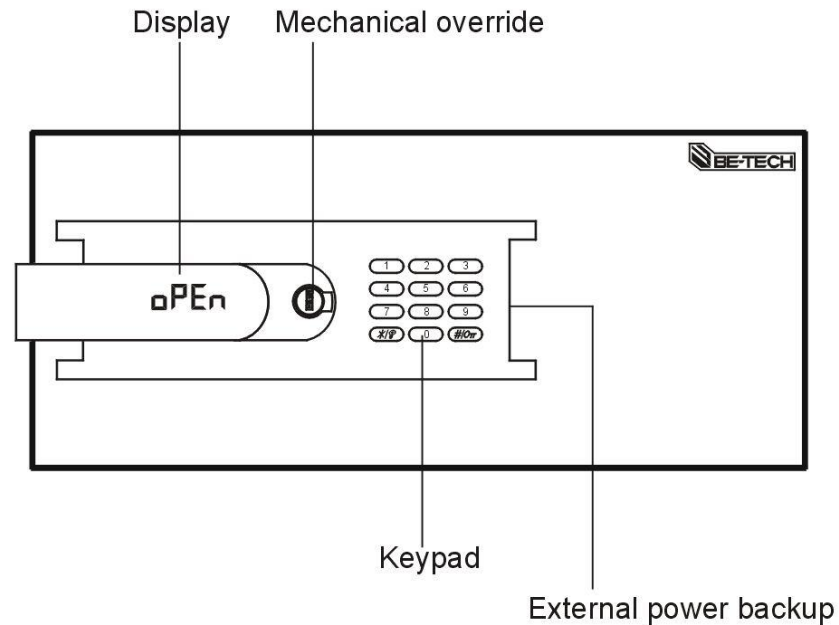

Securing the safe

To reduce the risk of theft, it is essential that your safe is securely fixed. Please use the included bolts and secure to a solid concrete floor. For maximum performance and correct installation a profession locksmith must install the safe.

! This product is heavy. Incorrect installation may result in injury.

Installing the batteries

1. Open the safe
2. Remove the battery cover located on the rear of the door.

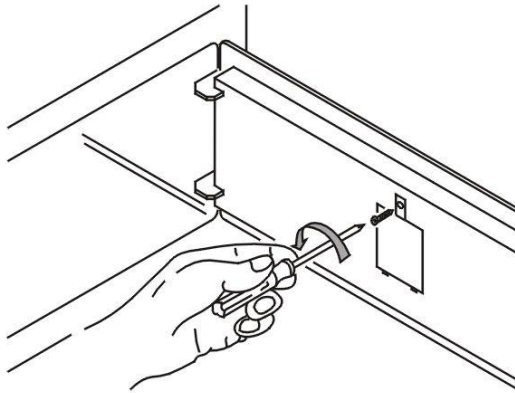

3. Place the batteries according to the illustration at the back of the battery compartment. Once the batteries are installed, close the battery cover plate.

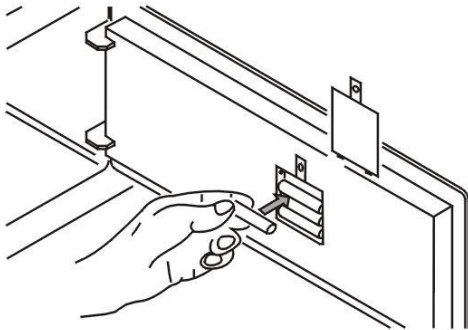

Before using your Be-tech safe, you must insert batteries. The safe requires 4XAA alkaline batteries. When batteries need changing the display will show **LoBt** together warning sound when you open the safe.

 Please note: Your settings are not reset when you change batteries.

Reset your safe

- ① Unlock door

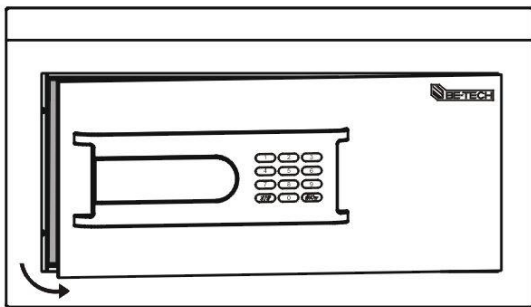

- ② Press the reset button with a long stick inserting to the small hole inside the battery compartment, a three tone beep will be heard, safe is to be factory settings.

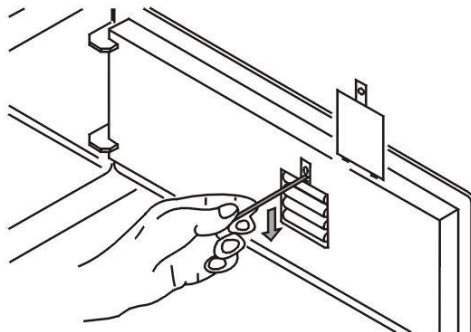

Setting your Master code

1 Unlock door

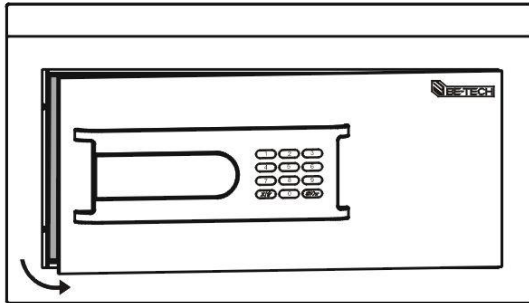

2 Press \ast/\varnothing → 1 → $\#/\text{OFF}$ ----

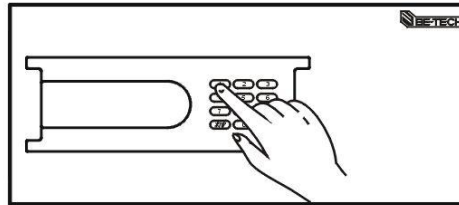

3 Display $\alpha\text{L}\text{C}\alpha$, enter 123456 → $\#/\text{OFF}$

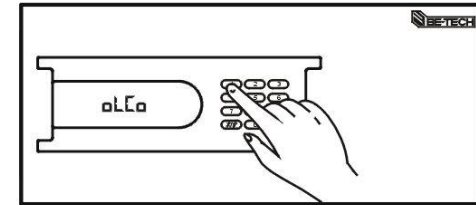

4 Display $\Xi\text{E}\text{C}\alpha$, enter new Master code → $\#/\text{OFF}$

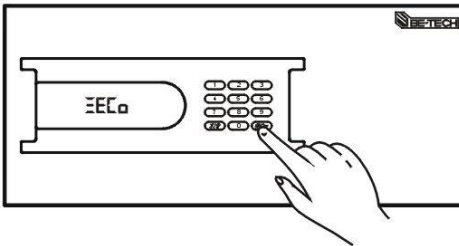

5 Display ΓEPE , repeat entering new Master code → $\#/\text{OFF}$

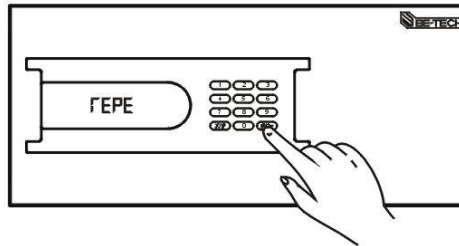

6 Display ΞUCC

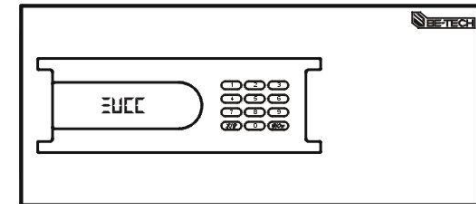

! Please note

1. If you have forgotten your code, use other ways to open the safe and press reset button and then re-set the Master code.
2. Your Master code does not have to be reprogrammed when you change the batteries.

Opening the safe

① Enter Master code → **#/0π**

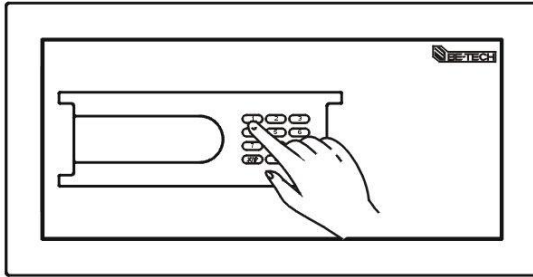

② Door open

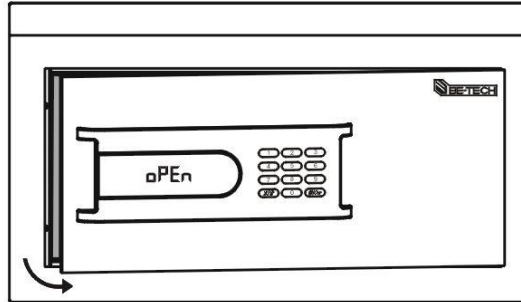

Closing the safe

① Close door

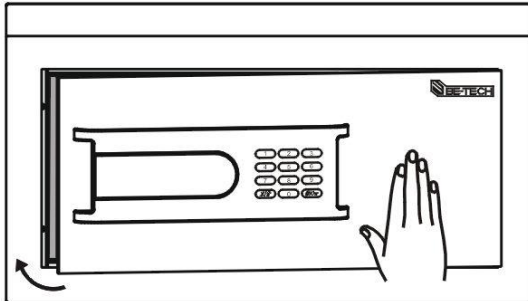

② Press **#/0π**

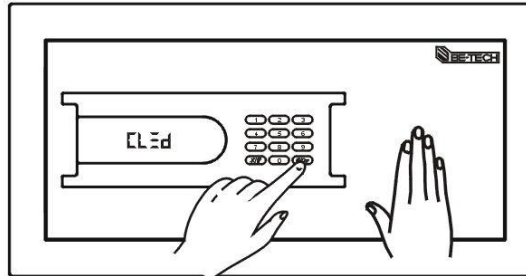

Setting your User code

1 Unlock door

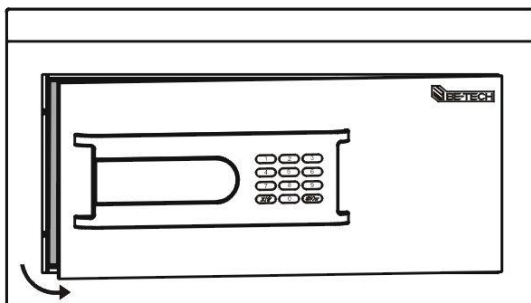

2 Press \ast/φ → 2 → $\#/0\pi$ ----

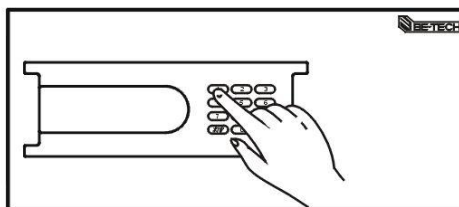

3 Display $\pi\Xi\zeta\alpha$, enter Master code → $\#/0\pi$

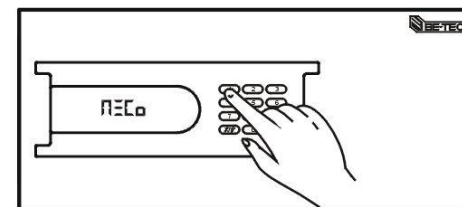

4 Display $\Xi\Xi\zeta\alpha$, enter a 4-9 digit code → $\#/0\pi$

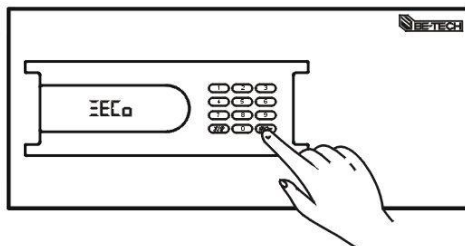

5 Display $\Gamma\epsilon\varphi\epsilon$, repeat entering new 4-9 digit code → $\#/0\pi$

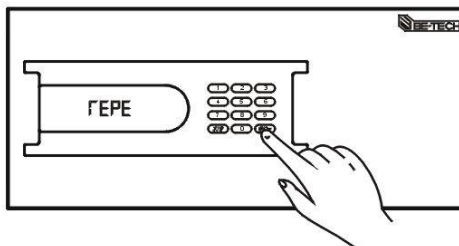

6 Display $\Xi\upsilon\zeta\zeta$

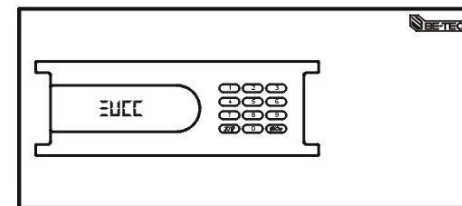

⚠ Please note: If the User code has been set, the display would show FULL when you press \ast/φ → 2 → $\#/0\pi$

Opening the safe

1 Enter User code → **#/0π**

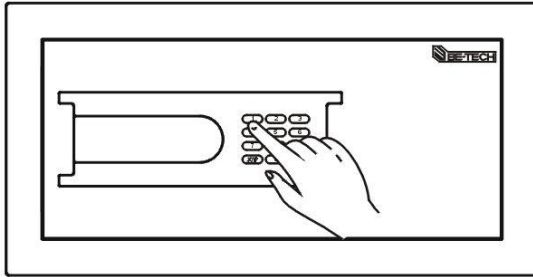

2 Door open

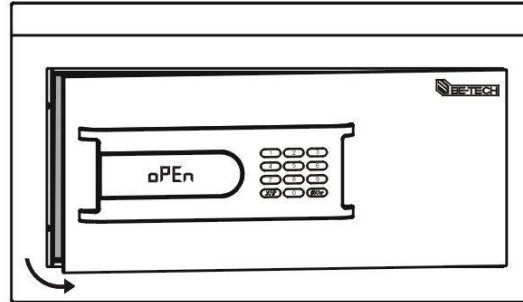

Closing the safe

1 Close door

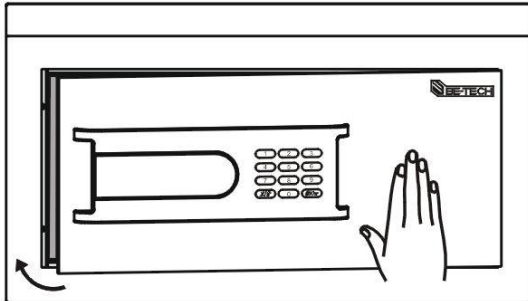

2 Press **#/0π**

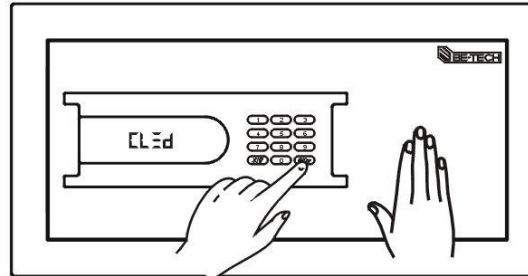

Deleting your User code

1 Unlock door

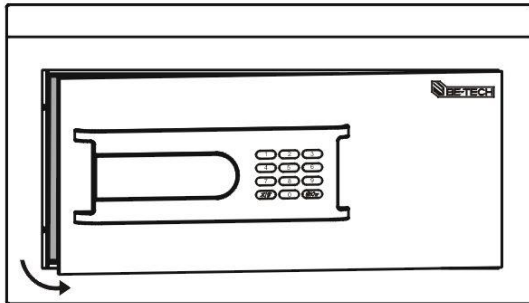

2 Press \ast/\varnothing → 3 → $\#/\text{On}$ ----

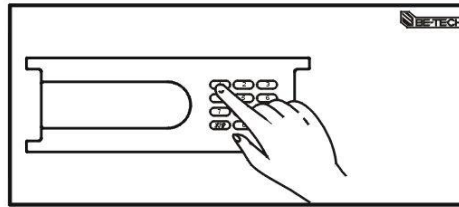

3 Display $\Pi\Xi\text{C}\square$, enter Master code → $\#/\text{On}$

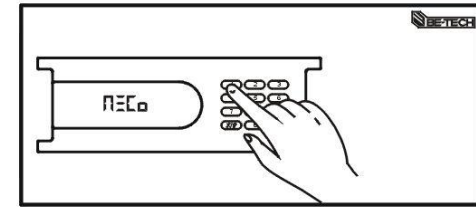

4 Display $\text{d}\Xi\text{C}\square$, repeat entering Master code → $\#/\text{On}$

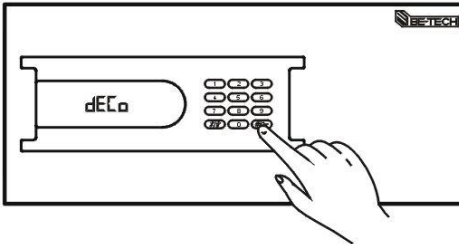

5 Display ΞUCC , User code is deleted

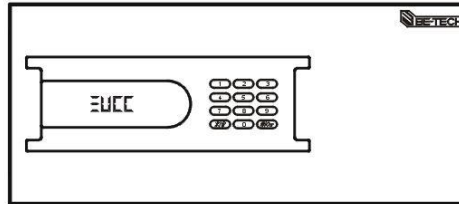

Show/Hide digits while entering code

Press ***P** → **4** → **#On**

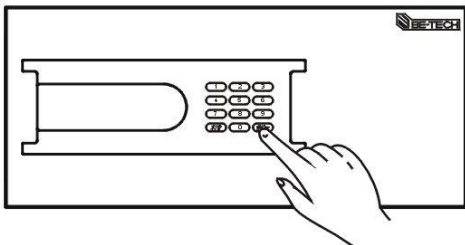

- If display shows **dP--** meaning: no input digits will be visible on the display when a code is entered.
- If display shows **dP□□** meaning: the code will be visible on the display when a code is entered.

Turning sound on/off

Press ***P** → **5** → **#On**

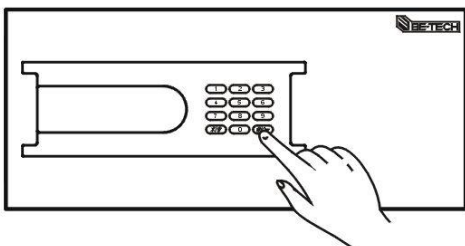

- If display shows **buzz** meaning: there is buzzer when operating the safe.
- If display shows **no buzz** meaning: there is no buzzer when operating the safe.

Enable/Disable security mode

① Press \ast/\varnothing → 5 → $\#/0\pi$

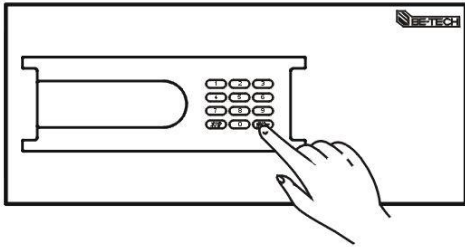

② Display $\pi\Xi\Gamma\alpha$, enter Master code → $\#/0\pi$

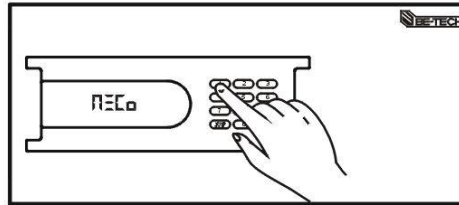

- If display shows $\Xi\Gamma\alpha$, meaning: you need to unlock the safe with either Code + User key or Code + Code.
- If display shows $\alpha\alpha\Gamma\alpha$ meaning: it is returned to normal mode.

! Under Security mode, it is unable to set Master code and User code, or delete User code, or show/hide digits while entering code, or turn sound on/off, unless disable security mode.

Operate under security mode

Opening the safe

Enter Master code → $\#/0\pi$

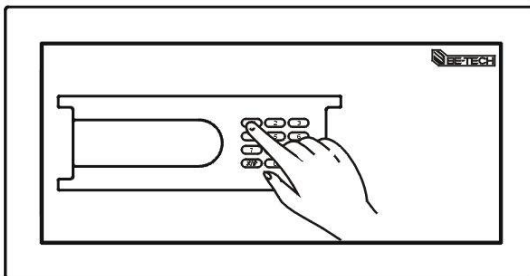

Display $\Xi\Gamma\alpha$, enter User code → $\#/0\pi$

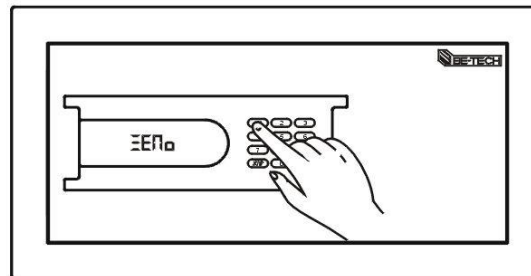

Display----- $\alpha\Gamma\Xi\pi$, door open

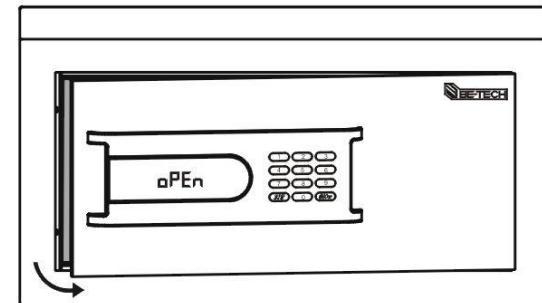

! Please note: Code scramble input function for privacy is not activity under Security mode.

Closing the safe

1 Close door

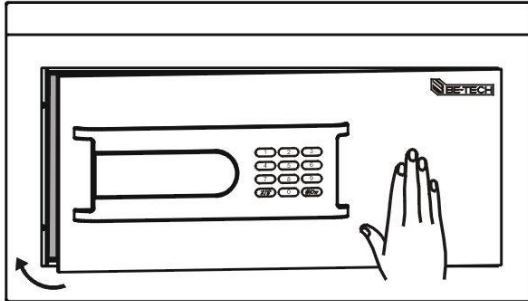

2 Press **#/0m**

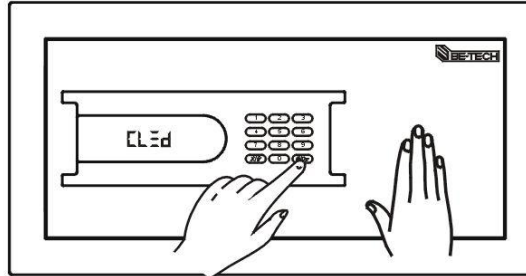

Re-activating the interior light

Press ***/***

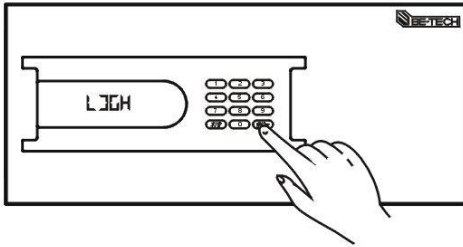

To re-activate the light press ***/***, the display shows **LIGH** and the light will be turned on for another 30 seconds. The light is automatically activated when the safe door is opened with the electronic keypad. The light can be reactivated at any time.

Code scramble input function for privacy

You can enter 11~16 digit code before the 4~9 user code (any digit code+ user code should be no more than 20 digits.) → **#00**, safe will be unlocked.

Low Voltage alarm

There will be 8 beeps when opening the safe, and the safe will display **Low**

Wrong-Try Lock-out

If incorrect User codes are attempted 3 times in a row, the safe will display **LOCK**, keypad light will flash, Buzzer will alarm for 1 minute, and then the key pad will lock-out for 2 minutes. This system will resume the operation automatically after 2 minutes of the lock-out.

Using the manual override key in emergency

- !** Please do not store the mechanical override keys inside the safe.
- For security reasons the key can not be removed and the electronic lock is deactivated when the safe is opened using the mechanical override key .To remove the key , you must lock the safe using the key.

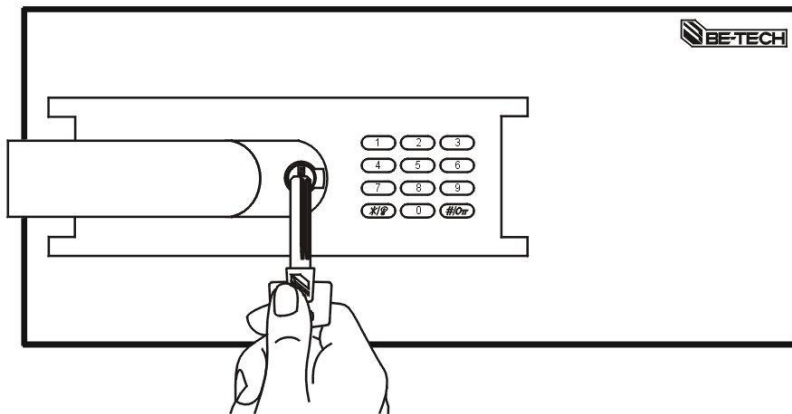

Opening the safe with emergency battery

If the batteries of the safe run out you can use a 9V battery to power up the lock.

- 1 Connect the 9V battery to external power back up min-usb port
- 2 Enter code → **#/0π**
- 3 Display-----**αPEπ**, door Open

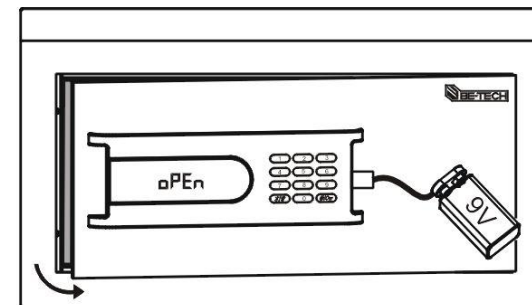
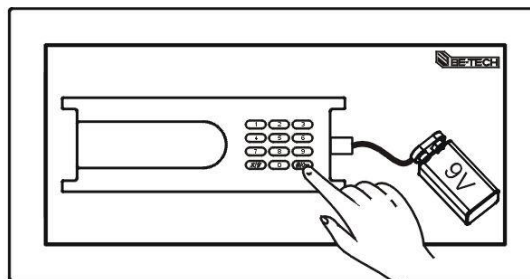
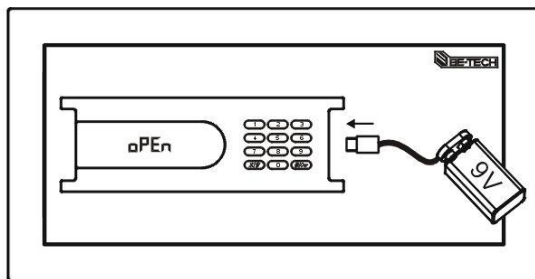

Programming Guide

List	Description
$\textcircled{*}/\textcircled{P} \rightarrow \textcircled{1} \rightarrow \textcircled{\#}/\textcircled{0\pi}$	To set new Master card
$\textcircled{*}/\textcircled{P} \rightarrow \textcircled{2} \rightarrow \textcircled{\#}/\textcircled{0\pi}$	To set User code
$\textcircled{*}/\textcircled{P} \rightarrow \textcircled{3} \rightarrow \textcircled{\#}/\textcircled{0\pi}$	To deleted User code
$\textcircled{*}/\textcircled{P} \rightarrow \textcircled{4} \rightarrow \textcircled{\#}/\textcircled{0\pi}$	To show/hide digits while entering code
$\textcircled{*}/\textcircled{P} \rightarrow \textcircled{5} \rightarrow \textcircled{\#}/\textcircled{0\pi}$	To enable/disable security mode
$\textcircled{*}/\textcircled{P} \rightarrow \textcircled{6} \rightarrow \textcircled{\#}/\textcircled{0\pi}$	To turn sound on/off

Description of display on the safe

List	Display on the safe	Description
Err	Err	Errors for incorrect Code or incorrect operation
Err1	Err1	Latch bolt does not reach corresponding place when opening
Err2	Err2	Latch bolt does not reach corresponding place when closing
LOBA	LOBA	Battery low voltage
LOCK	LOCK	Keypad locked down
OPEN	OPEN	Success to open
CLSD	CLSD	Success to close
OLCO	OLCO	Please enter old Master code
LIGH	LIGH	LED light on
SECO	SECO	Please enter new code
REPE	REPE	Repeat last operation
MSCO	MSCO	Please enter Master code
FULL	FULL	Memory full
DECO	DECO	Delete code
Succ	Succ	Setup success
Dp--	Dp--	Display---
DpCO	DpCO	Display code
BUZZ	BUZZ	Buzzer, Turning sound on when pressing buttons
SILE	SILE	Silence: Turning of sound when pressing buttons
SEMO	SEMO	Enable security mode
NoMo	NoMo	Disable security mode

The safe is delivered with the following items supplied separately inside the box:



User manual

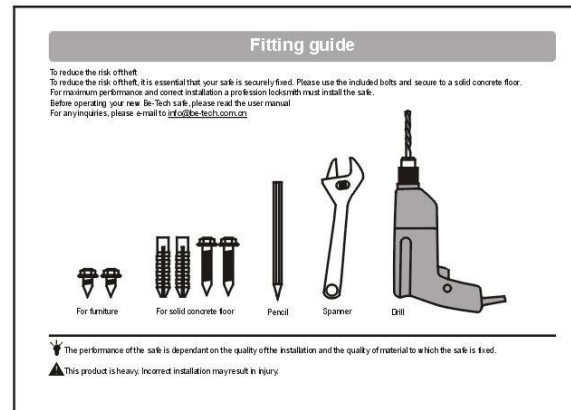

Fitting guide

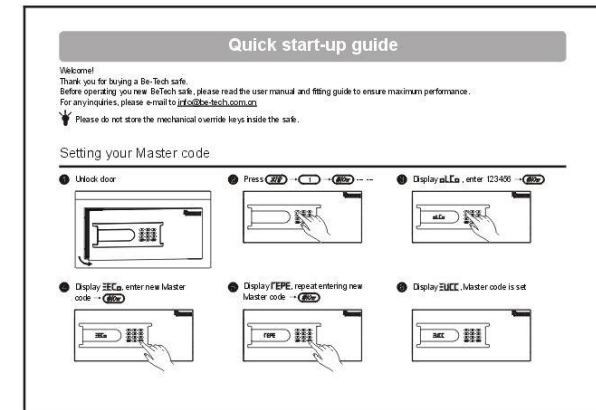

Quick Start-up guide

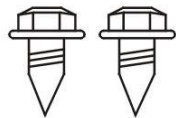

For furniture

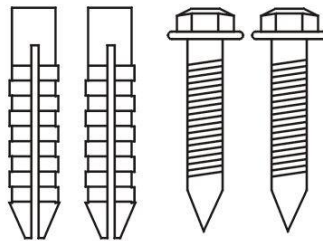

For solid concrete floor

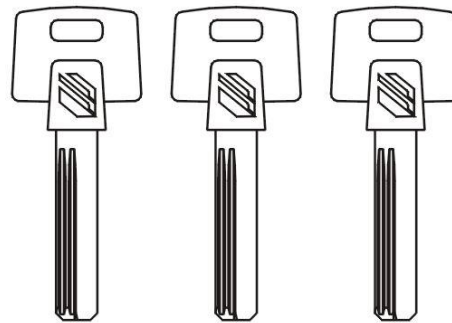

3 X Manual override keys



External power backup connector

Contacting Support

For additional product information including instructional videos.

Please visit us online at: www.betech-security.com

Via email: info@be-tech.com.cn

Directly at: GUANGDONG BE-TECH SECURITY SYSTEMS LIMITED

No.17, Keyuan 3 Road, Ronggui, Shunde High-Tech Zone, Foshan, Guangdong, P.R.China.

Phone: 86-757-2830 8833

Fax: 86-757-2830 8823

Smart Your Life

GUANGDONG BE-TECH SECURITY SYSTEMS LIMITED

Add: No.17, Keyuan 3 Road, Ronggui, Shunde High-Tech Zone, Foshan,
Guangdong, P.R.China.

Tel: 86-757-2830 88333 Fax: 86-757-2830 8823

<http://www.be-tech.com.cn>

Email: export@be-tech.com.cn