



# Electronic Safe

## User Manual

For models:

PREMIUM-10GL (Home size)

PREMIUM-3GL (Laptop size)

PREMIUM-2GL (Office size)

PREMIUM-6GL (Compact size)

*Focus on Smart Lock  
Since 1992*

# Fitting guide

To reduce the risk of theft

To reduce the risk of theft, it is essential that your safe is securely fixed. Please use the included bolts and secure to a solid concrete floor.

For maximum performance and correct installation a profession locksmith must install the safe.

Before operating your new Be-Tech safe, please read the user manual

For any inquiries, please e-mail to [info@be-tech.com.cn](mailto:info@be-tech.com.cn)

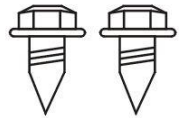

For furniture

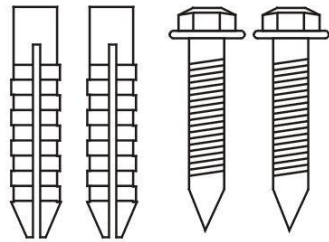

For solid concrete floor



Pencil

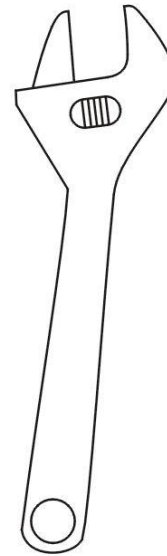

Spanner

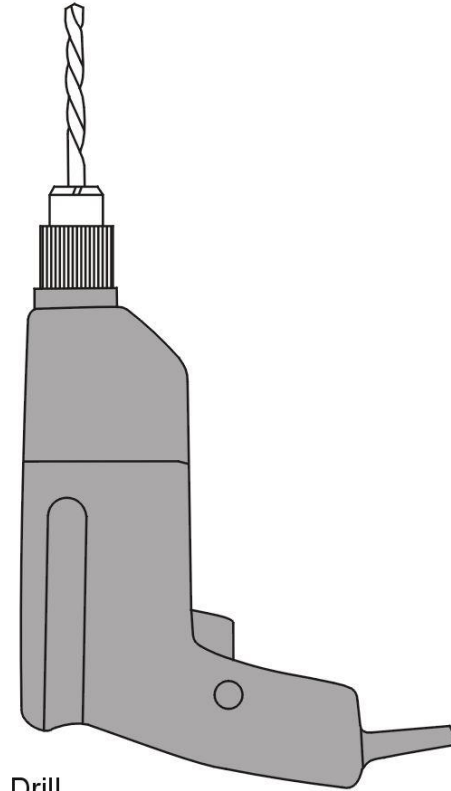

Drill

---

 The performance of the safe is dependant on the quality of the installation and the quality of material to which the safe is fixed.

 This product is heavy. Incorrect installation may result in injury.

Before fixing the safe please ensure:

- That the safe is placed horizontally
  - To keep the safe in a dry environment to prevent corrosion to the safe and locking mechanism
  - To use the fixing bolts provided for installation on a solid concrete floor.
- 

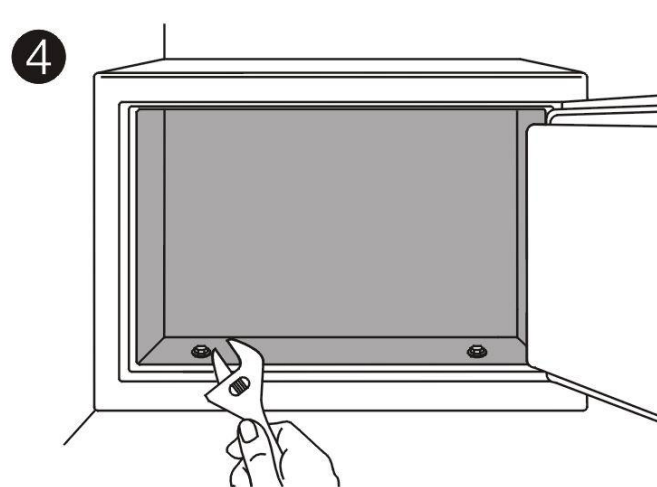
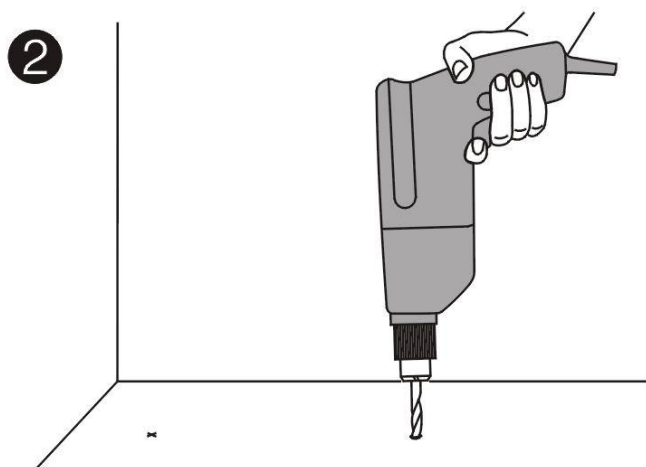
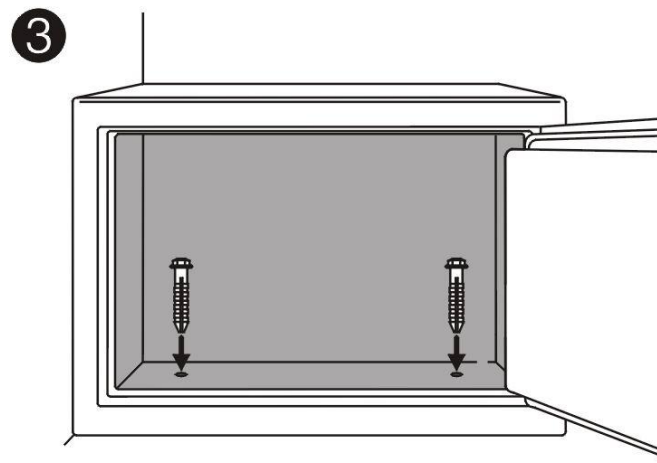
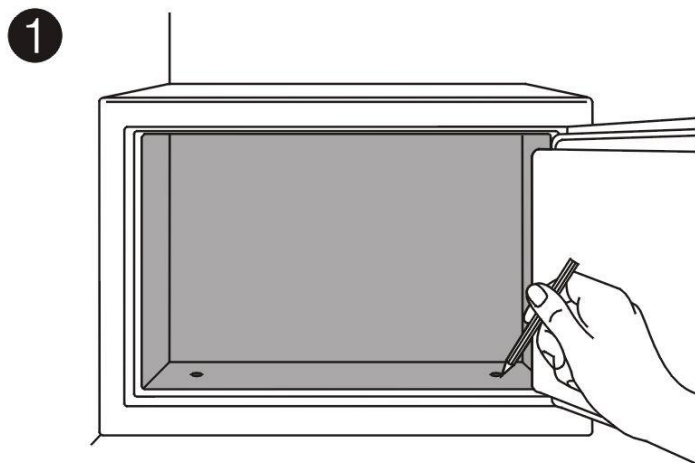

- 
1. Mark the position of the safe through fixing holes.
  2. Remove the safe and drill the holes as marked.
  3. Reposition the safe over the holes

4. Drop the bolts through the safe and into the drilled holes. You may have use a hammer to drive the bolts down.
5. Tighten the fixing bolts firmly and ensure there is no movement of the safe

# Quick start-up guide

Welcome!

Thank you for buying a Be-Tech safe.

Before operating your new BeTech safe, please read the user manual and fitting guide to ensure maximum performance.

For any inquiries, please e-mail to [info@be-tech.com.cn](mailto:info@be-tech.com.cn)



Please do not store the mechanical override keys inside the safe.

## Setting your Master code

1 Unlock door

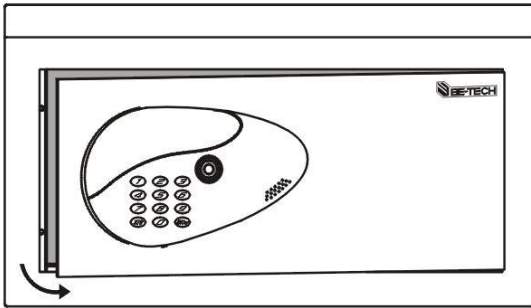

2 Press  $\ast/\text{P}$  → 1 → #/0π -----

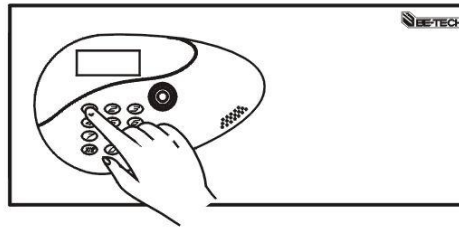

3 Display 0L0, enter 123456 → #/0π

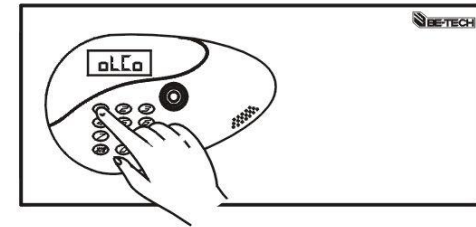

4 Display 3EE0, enter new Master code → #/0π

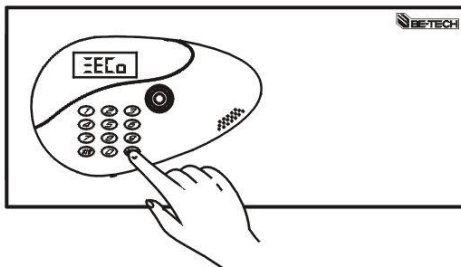

5 Display 7EPE, repeat entering new Master code → #/0π

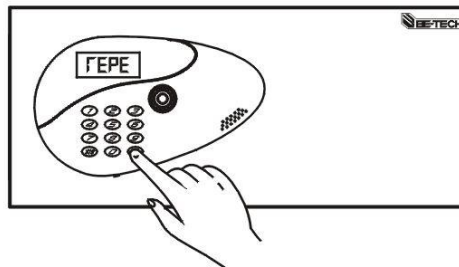

6 Display 3UCC, Master code is set

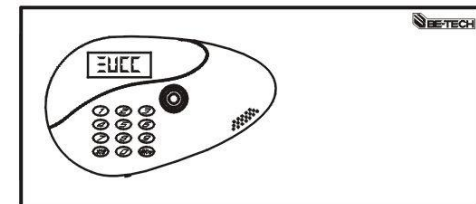

# Opening the safe

---

1 Enter Master code → #/0rr

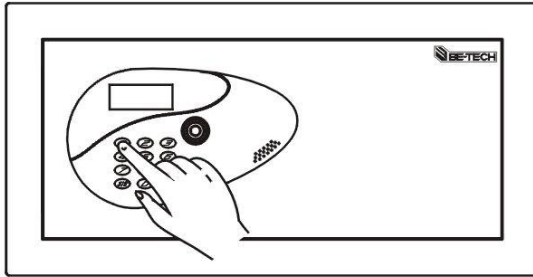

2 Door open

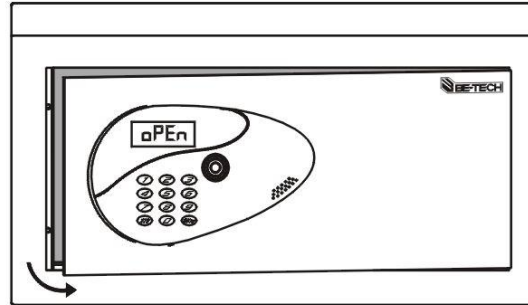

# Closing the safe

---

1 Close door

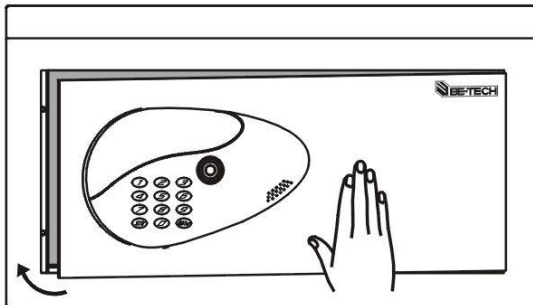

2 Press #/0rr

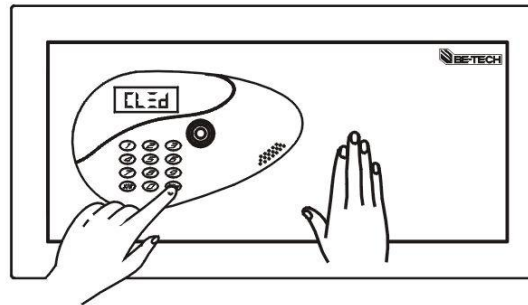

UM-33x	A
--------	---

# Safe overview

---

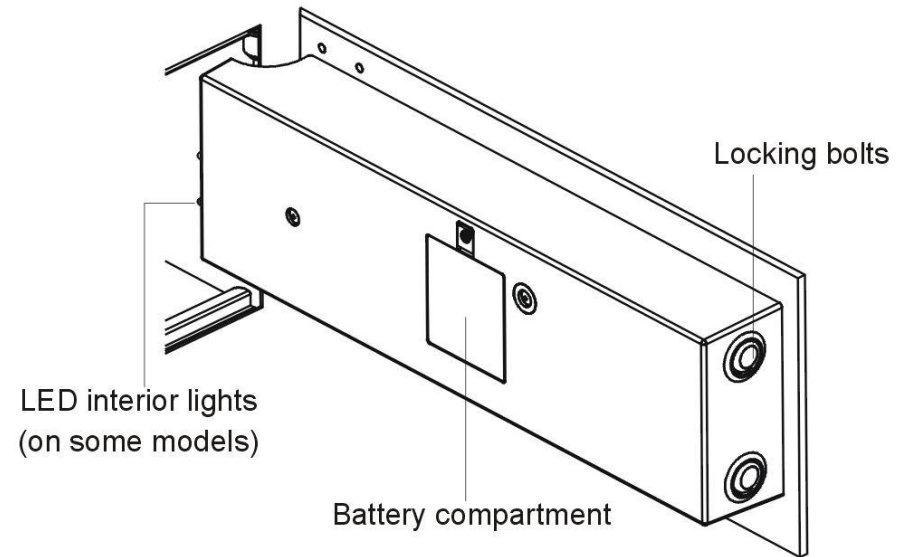
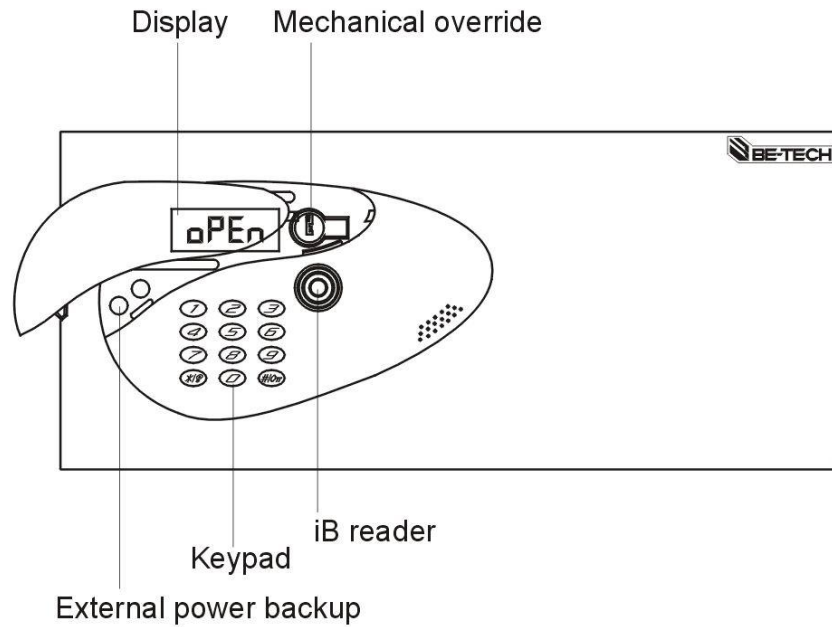

## Securing the safe

---

To reduce the risk of theft, it is essential that your safe is securely fixed. Please use the included bolts and secure to a solid concrete floor. For maximum performance and correct installation a profession locksmith must install the safe.

**!** This product is heavy. Incorrect installation may result in injury.

# Installing the batteries

---

1. Open the safe
2. Remove the battery cover located on the rear of the door.

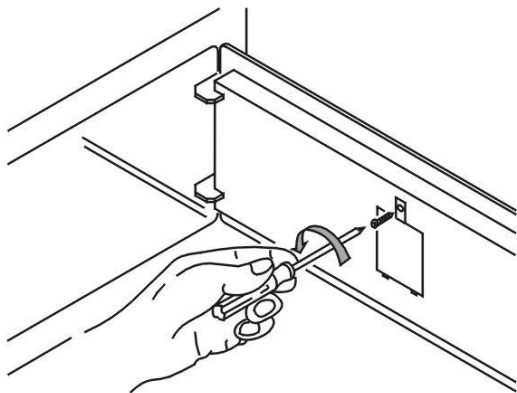

3. Place the batteries according to the illustration at the back of the battery compartment. Once the batteries are installed, close the battery cover plate.

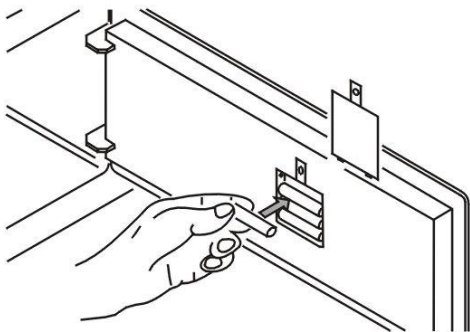

Before using your Be-tech safe, you must insert batteries. The safe requires 4XAA alkaline batteries. When batteries need changing the display will show **LoBt** together warning sound when you open the safe.

 Please note: Your settings are not reset when you change batteries.



# Reset your safe

---

① Unlock door

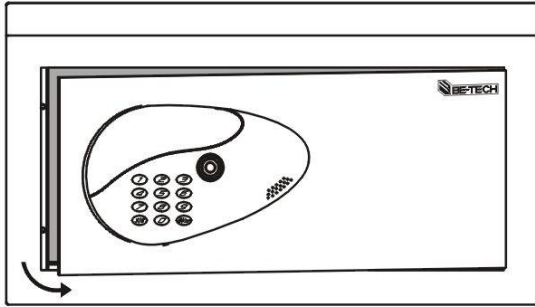

② Press the reset button with a long stick inserting to the small hole inside the battery compartment, a three tone beep will be heard, safe is to be factory settings.

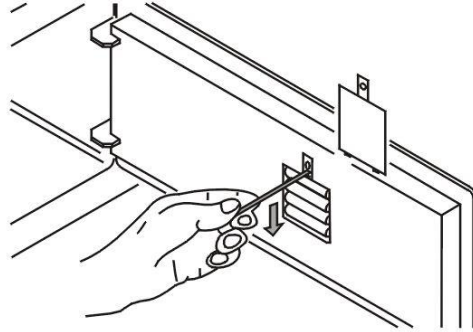

# Setting your Master code

1 Unlock door

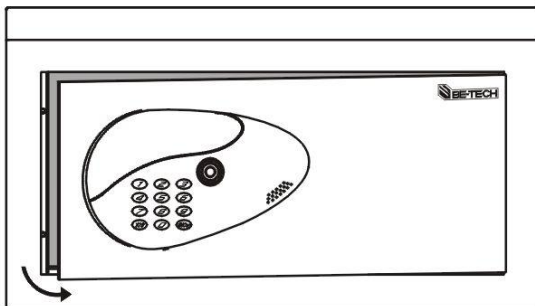

2 Press  $\ast/\text{P}$  → 1 → #/0

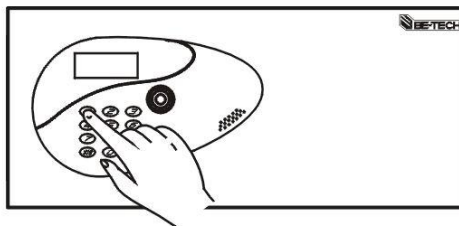

3 Display  $\alpha\text{L}\square$ , enter 123456 → #/0

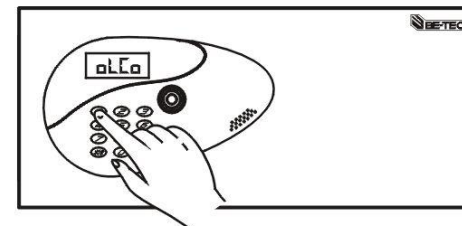

4 Display  $\Xi\text{E}\square$ , enter new Master code → #/0

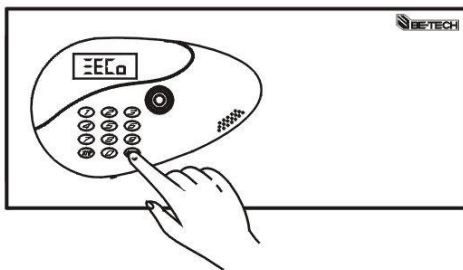

5 Display  $\Gamma\text{EPE}$ , repeat entering new Master code → #/0

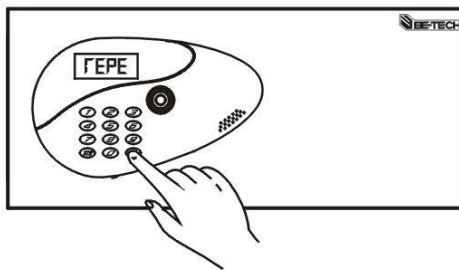

6 Display  $\Xi\text{UCE}$

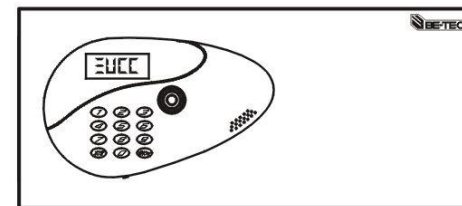

## ⚠ Please note

1. If you have forgotten your code, use other ways to open the safe and press reset button and then re-set the Master code.
2. Your Master code does not have to be reprogrammed when you change the batteries.

# Opening the safe

---

1 Enter Master code → #/0π

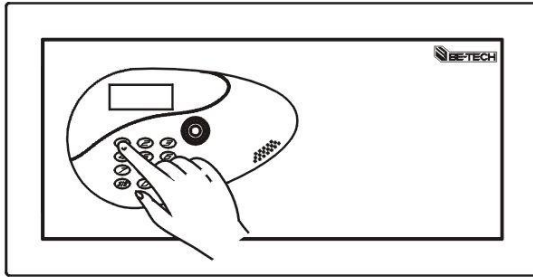

2 Door open

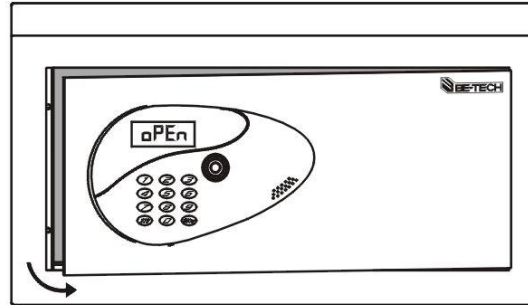

# Closing the safe

---

1 Close door

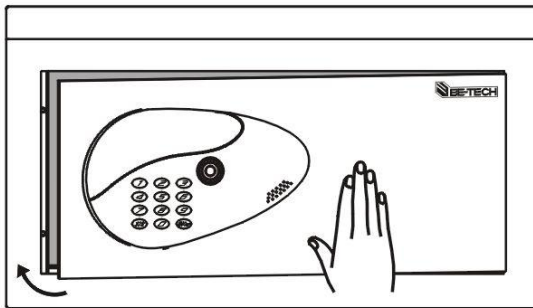

2 Press #/0π

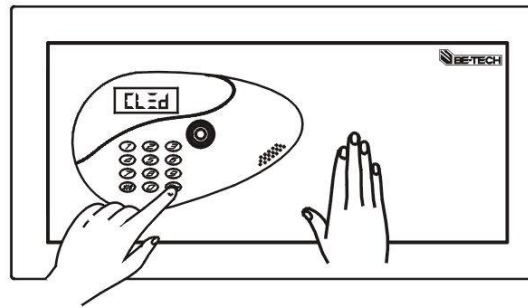

# Setting your User code

1 Unlock door

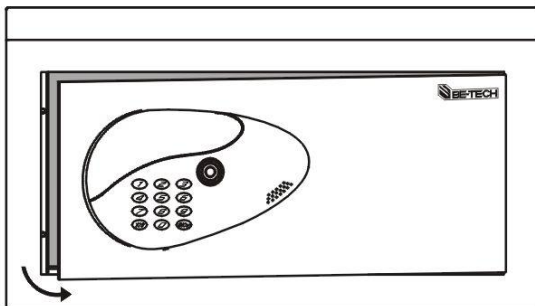

2 Press  $\ast/\varphi$  → 2 → #/0π -----

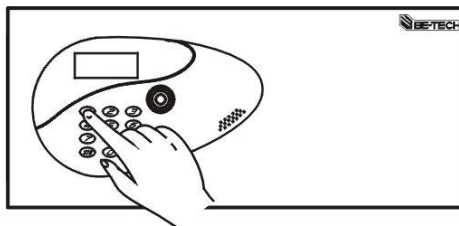

3 Display ΠΕΕ□, enter Master code → #/0π

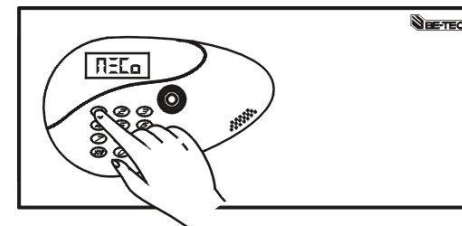

4 Display ΕΕ□□, enter a 4-9 digit code → #/0π

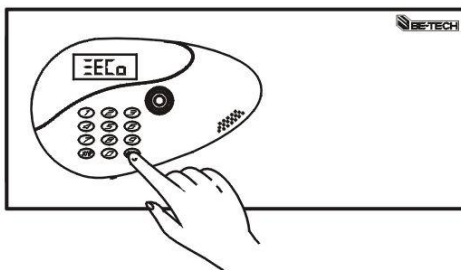

5 Display ΓΕΡΕ, repeat entering the 4-9 digit code → #/0π

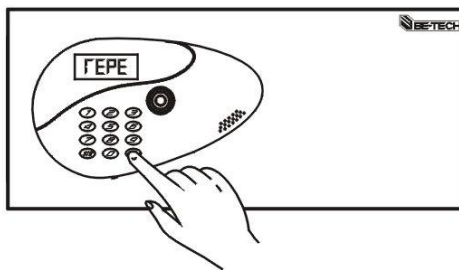

6 Display ΕΥΕΕ

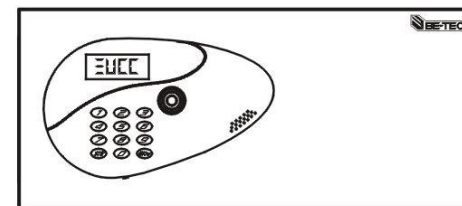

⚠ Please note: If the User code has been set, the display would show FULL when you press  $\ast/\varphi$  → 2 → #/0π

# Opening the safe

---

1 Enter User code → #/0\*

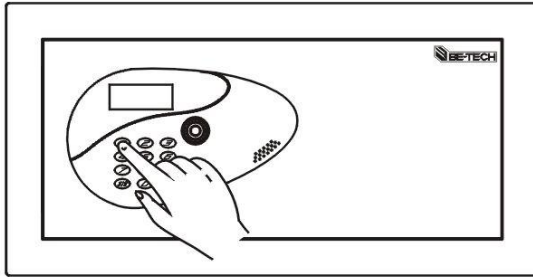

2 Door open

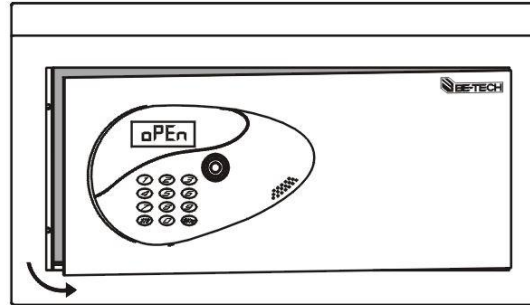

# Closing the safe

---

1 Close door

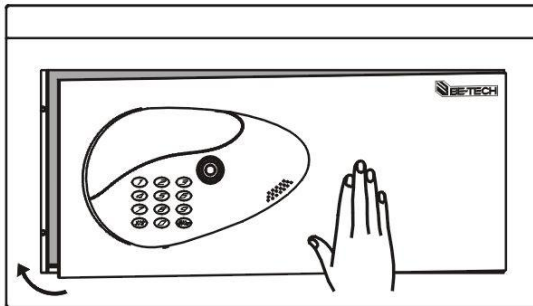

2 Press #/0\*

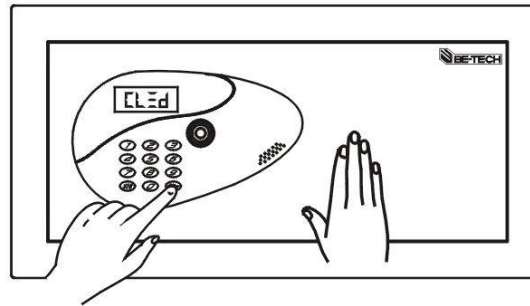

# Deleting your User code

1 Unlock door

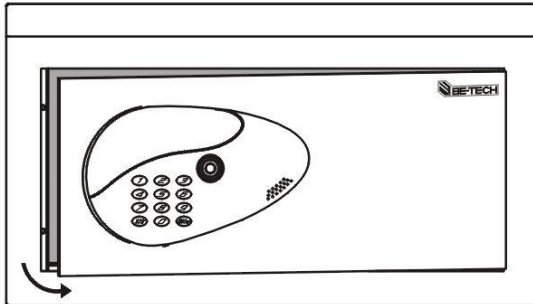

2 Press  $\ast/\text{P}$  →  $\text{E}$  →  $\#/\text{O}\pi$  ----

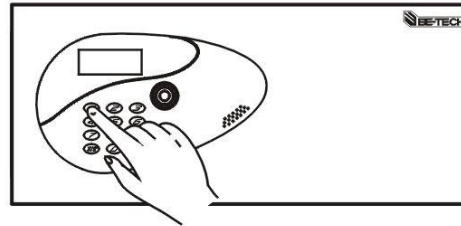

3 Display  $\text{P}\text{E}\text{C}\square$ , enter Master code →  $\#/\text{O}\pi$

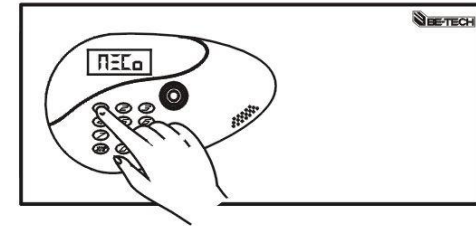

4 Display  $\text{d}\text{E}\text{C}\square$ , repeat entering Master code →  $\#/\text{O}\pi$

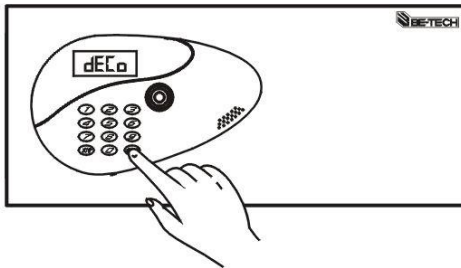

5 Display  $\text{E}\text{U}\text{C}\text{C}$ , User code is deleted

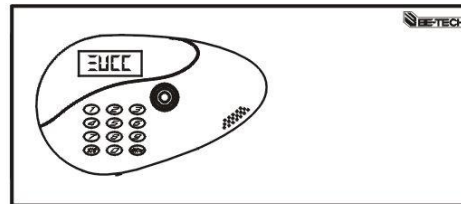

# Show/Hide digits while entering code

---

Press **\***/**P** → **4** → **#**/**O**/**m**

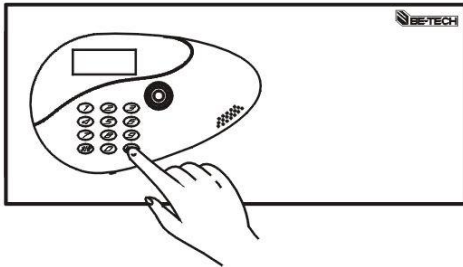

- If display shows **dP--** meaning: no input digits will be visible on the display when a code is entered.
- If display shows **dP□□** meaning: the code will be visible on the display when a code is entered.

# Turning sound on/off

---

Press **\***/**P** → **5** → **#**/**O**/**m**

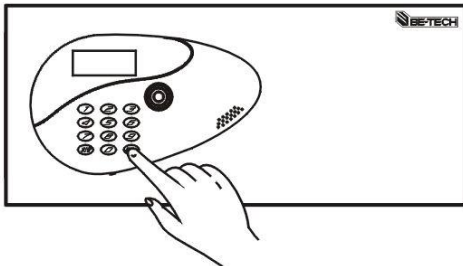

- If display shows **bUZZ** meaning: there is buzzer when operating the safe.
- If display shows **≡LE** meaning: there is no buzzer when operating the safe.

# Enable/Disable security mode

1 Press  $*1\text{P}$  →  $5$  →  $\#10\text{m}$

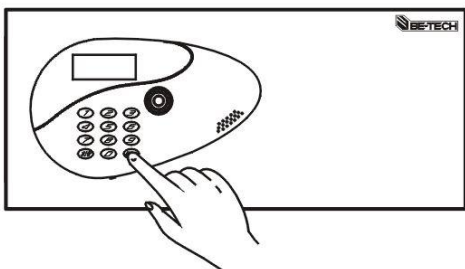

2 Display  $\text{P}\equiv\text{L}\square$ , enter Master code →  $\#10\text{m}$

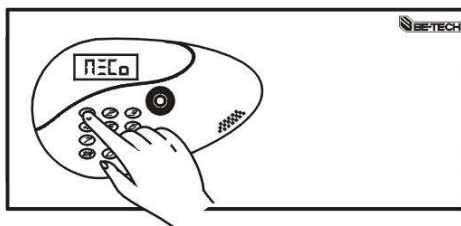

- If display shows  $\equiv\text{E}\text{P}\square$ , meaning: you need to unlock the safe with either Code + User key or Code + Code.
- If display shows  $\text{no}\text{P}\square$  meaning: it is returned to normal mode.

**!** Under Security mode, it is unable to set Master code, User code and User key, or delete User code and Use key, or show/hide digits while entering code, or turn sound on/off, unless disable security mode.

# Operate under security mode

## Opening the safe

### Combination 1

Enter Master code →  $\#10\text{m}$

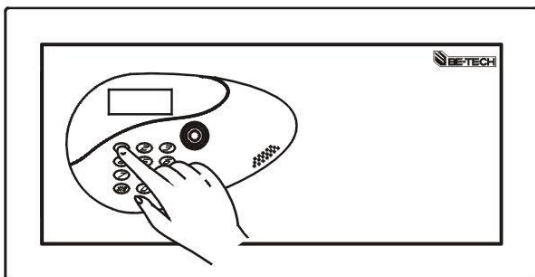

Display  $\equiv\text{E}\text{P}\square$ , enter User code →  $\#10\text{m}$

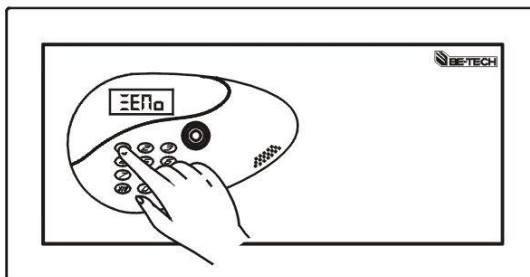

Display----- $\square\text{P}\text{E}\text{n}$ , door open

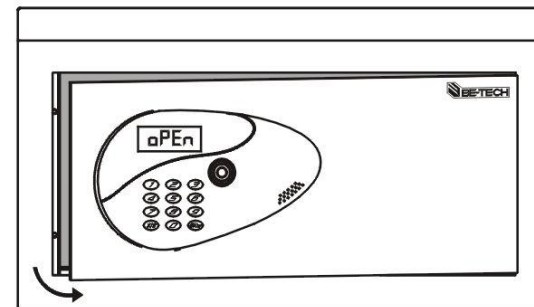



## Combination 2

Contact User key

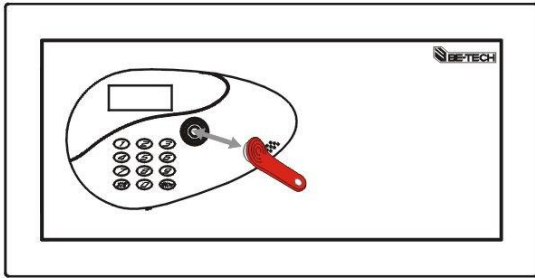

Display  $\Xi E \Pi \alpha$ , enter Master code  $\rightarrow \# / 0 \pi$

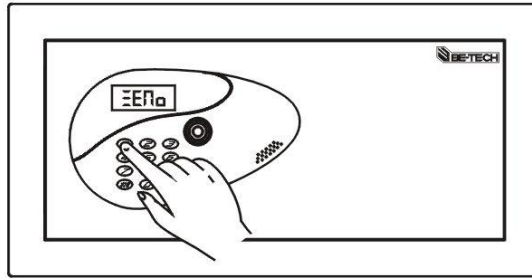

Display----- $\alpha P E \pi$ , door open

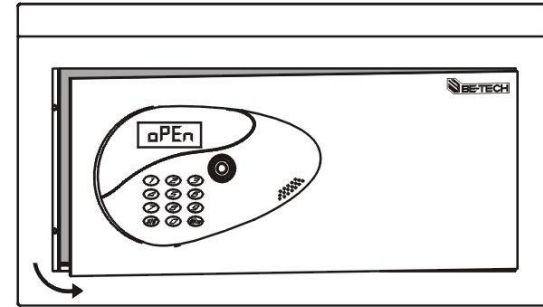

## Combination 3

Contact User key

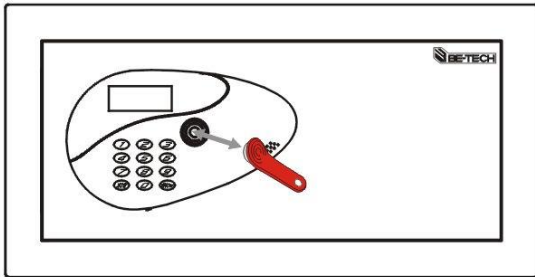

Display  $\Xi E \Pi \alpha$ , enter User code  $\rightarrow \# / 0 \pi$

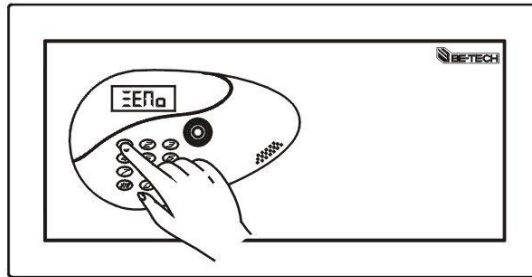

Display----- $\alpha P E \pi$ , door open

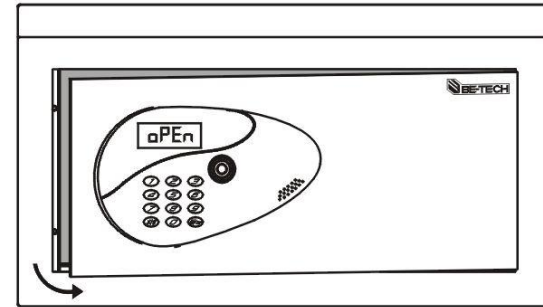

**!** Please note

1. Code scramble input function for privacy is not activity under Security mode.
2. User key must be preset while on combination 2 and combination 3.

# Closing the safe

---

1 Close door

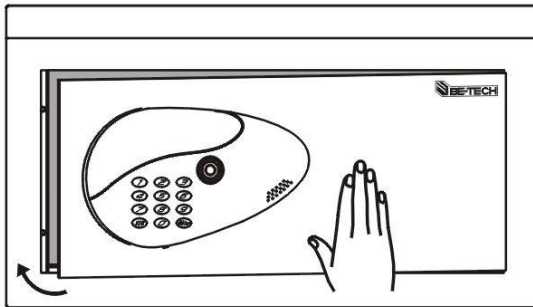

2 Press #/0\*

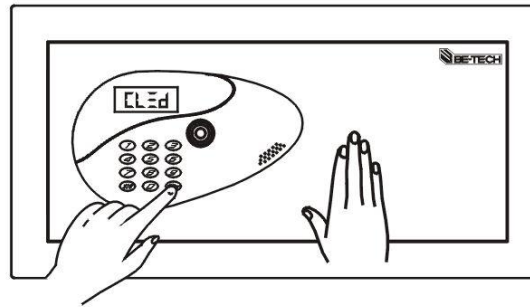

# Setting User key

1 Unlock door

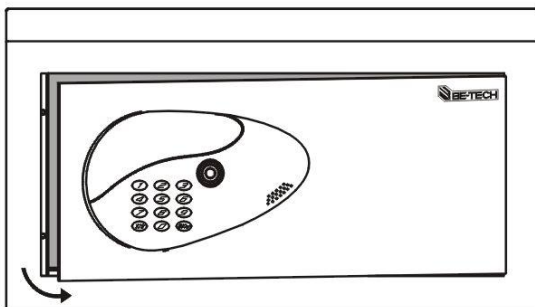

2 Press  $\ast/\varphi$  → 7 → #/0π

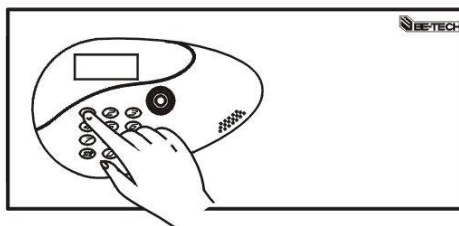

3 Display  $\pi\pi\pi\pi$ , enter Master code → #/0π

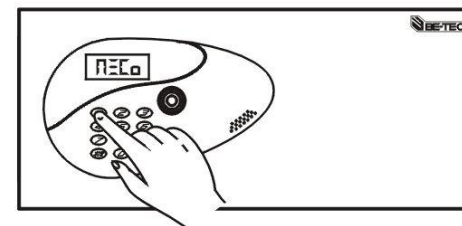

4 Display  $\pi\pi\pi\pi$ , contact IB key

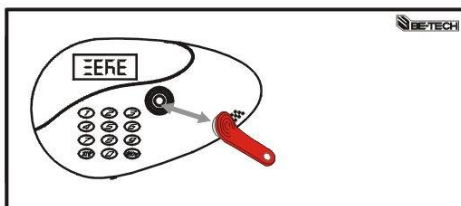

5 Display  $\pi\pi\pi\pi$ , repeat contacting IB key

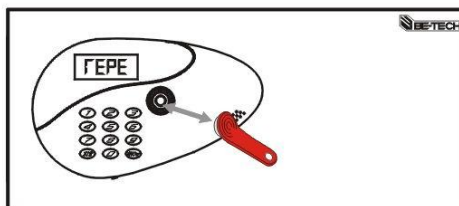

6 Display  $\pi\pi\pi\pi$ , User key is set

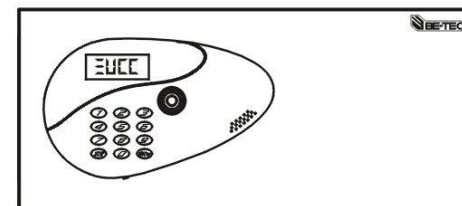

⚠ Please note: If the User key has been set, the display would show FULL when you press  $\ast/\varphi$  → 7 → #/0π

# Opening the safe

---

1 Contact User key → #/0\*

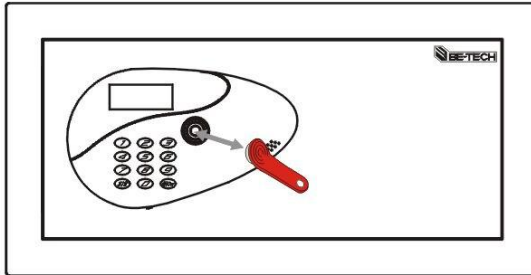

2 Door open

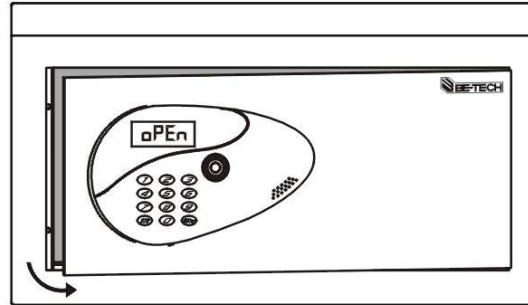

# Closing the safe

---

1 Close door

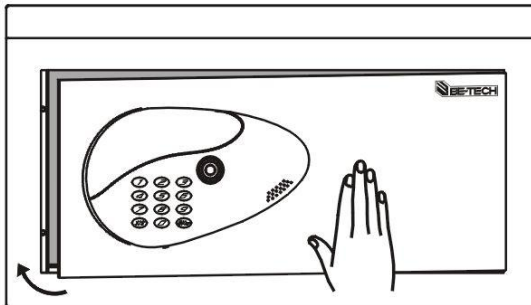

2 Press #/0\*

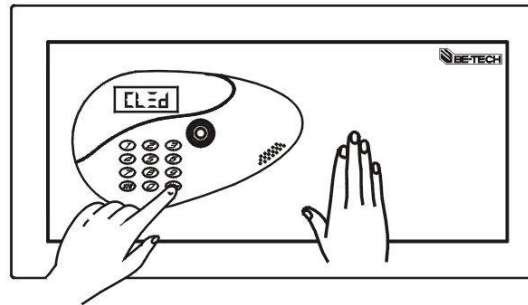

# Deleting Use key

1 Unlock door

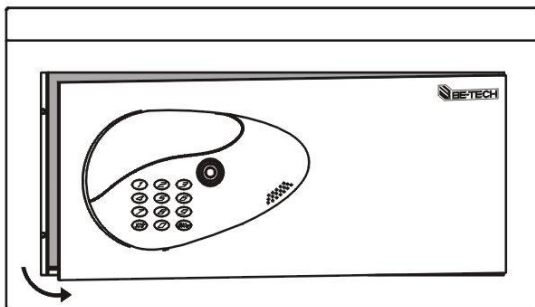

2 Press  $\ast/\text{P}$  →  $\text{E}$  →  $\#/\text{O}\pi$

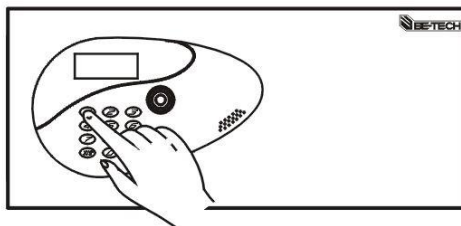

3 Display  $\text{P}\text{E}\text{E}\square$ , enter Master code →  $\#/\text{O}\pi$

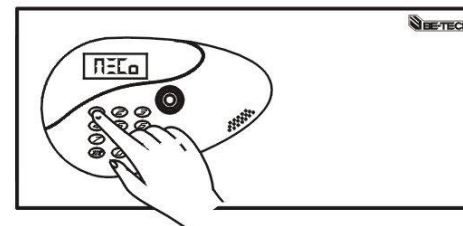

4 Display  $\text{dE}\text{E}\text{E}$ , enter Master code →  $\#/\text{O}\pi$

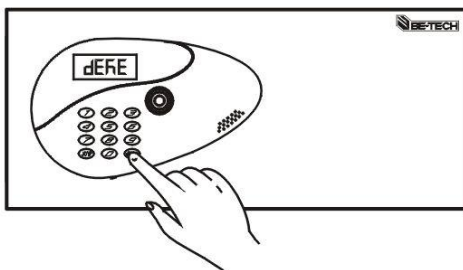

5 Display  $\text{E}\text{E}\text{E}\text{E}$ , repeat entering Master code →  $\#/\text{O}\pi$

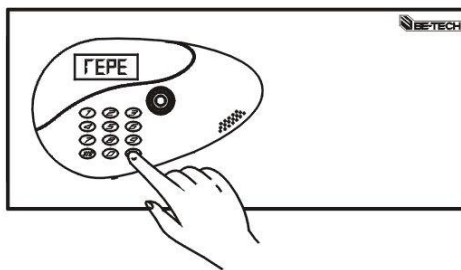

6 Display  $\text{E}\text{U}\text{E}\text{E}$ , User key is deleted

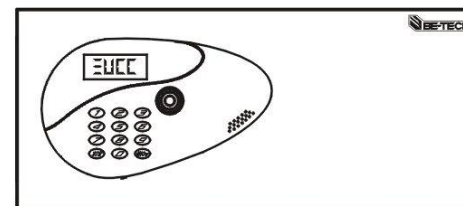

## Re-activating the interior light

---

Press 

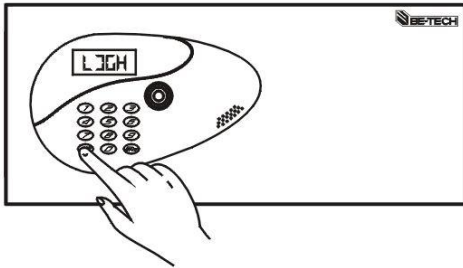

To re-activate the light press , the display shows **L 3EH** and the light will be turned on for another 30 seconds. The light is automatically activated when the safe door is opened with the electronic keypad. The light can be reactivated at any time.

## Code scramble input function for privacy

---

You can enter 11~16 digit code before the 4~9 user code (any digit code+ user code should be no more than 20 digits.) → , safe will be unlocked.

## Low Voltage alarm

---

There will be 8 beeps when opening the safe, and the safe will display **L 0bA**

## Wrong-Try Lock-out

---

If incorrect User codes or unregistered card key are attempted 3 times in a row, the safe will display **L 0cA**, keypad light will flash, Buzzer will alarm for 1 minute, and then the key pad will lock-out for 2 minutes. This system will resume the operation automatically after 2 minutes of the lock-out. If you contact a registered card key, it resumes the operation.

# Using the manual override key in emergency

- !** Please do not store the mechanical override keys inside the safe.  
For security reasons the key can not be removed and the electronic lock is deactivated when the safe is opened using the mechanical override key .To remove the key , you must lock the safe using the key.

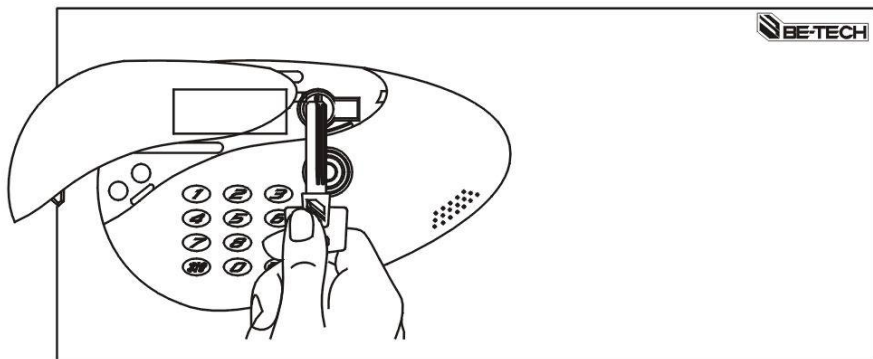

# Opening the safe with emergency battery

If the batteries of the safe run out you can use a 9V battery to power up the lock.

- 1** Connect the battery to the 9V battery port by sliding the cover

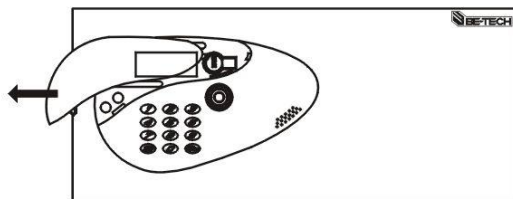

- 2** Enter code → **#10π**

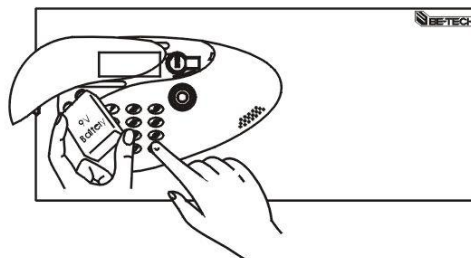

- 3** Display-----**OPEN**, door Open

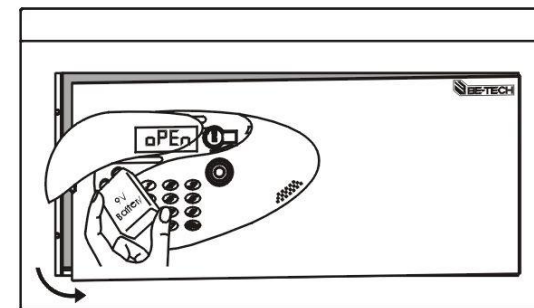

# Programming Guide

---

List	Description
*1P → 1 → #10m	To set new Master card
*1P → 2 → #10m	To set User code
*1P → 3 → #10m	To deleted User code
*1P → 4 → #10m	To show/hide digits while entering code
*1P → 5 → #10m	To enable/disable security mode
*1P → 6 → #10m	To turn sound on/off
*1P → 7 → #10m	To set User key
*1P → 8 → #10m	To delete User key



# Description of display on the safe

---

List	Display on the safe	Description
Err	Err	Errors for incorrect Code or incorrect operation
Err1	Err1	Latch bolt does not reach corresponding place when opening
Err2	Err2	Latch bolt does not reach corresponding place when closing
LOBA	LoBa	Battery low voltage
LOCK	LoCK	Keypad locked down
OPEn	oPEn	Success to open
CLSd	CLEd	Success to close
OLCO	oLCo	Please enter old Mater code
LIGH	LIgH	LED lighti on
SECO	SECo	Please enter new code
REPE	REPE	Repeat last operation
MSCO	MSCo	Please enter Master code
FULL	FULL	Memory full
DECO	dECo	Delete code
Succ	SUCC	Setup success
Dp--	dP--	Display---
DpCO	dPCo	Display code
BUZZ	bUZZ	Buzzer, Turning sound on when pressing buttons
SILE	SILE	Silence: Turning of sound when pressing buttons
SEMO	SEMo	Enable security mode
NoMo	NoMo	Disable security mode
Seke	SEKE	Set User key
DEKe	dEFE	Delete User key

# The safe is delivered with the following items supplied separately inside the box:



User manual

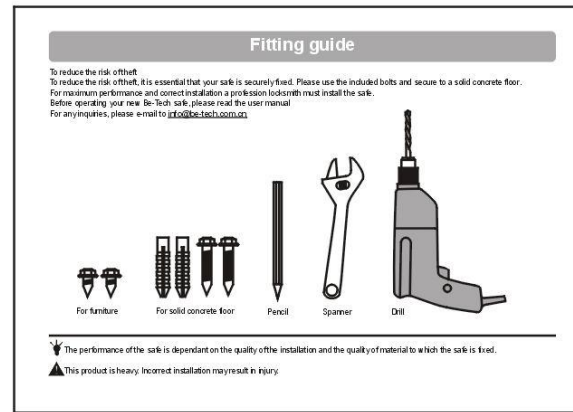

Fitting guide

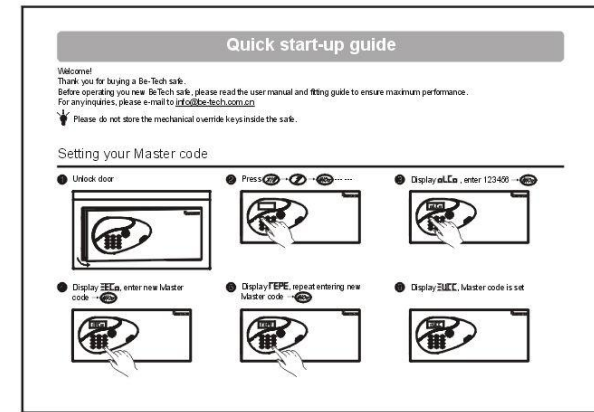

Quick Start-up guide

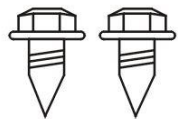

For furniture

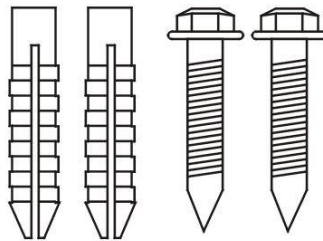

For solid concrete floor

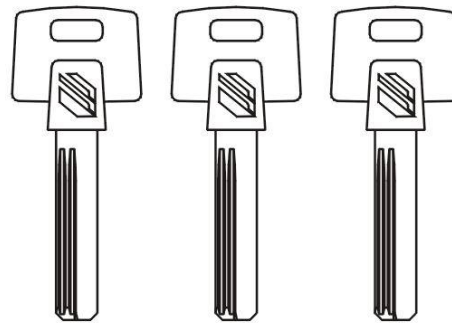

3 X Manual override keys

# Contacting Support

For additional product information including instructional videos.

**Please visit us online at:** [www.betech-security.com](http://www.betech-security.com)

**Via email:** [info@be-tech.com.cn](mailto:info@be-tech.com.cn)

**Directly at: GUANGDONG BE-TECH SECURITY SYSTEMS LIMITED**

No.17, Keyuan 3 Road, Ronggui, Shunde High-Tech Zone, Foshan, Guangdong, P.R.China.

Phone: 86-757-2830 8833

Fax: 86-757-2830 8823

*Smart Your Life*

**GUANGDONG BE-TECH SECURITY SYSTEMS LIMITED**

Add: No.17, Keyuan 3 Road, Ronggui, Shunde High-Tech Zone, Foshan,  
Guangdong, P.R.China.

Tel: 86-757-2830 88333 Fax: 86-757-2830 8823

<http://www.be-tech.com.cn>

Email: [export@be-tech.com.cn](mailto:export@be-tech.com.cn)